

# BRUCE MATHER

---

## INDEPENDENT ESTATE AGENT



### **Romar Spilsby Road, Boston, PE22 8JT**

### **Asking Price £225,000**

A three-bedroom detached bungalow with a picturesque outlook and attractive garden, in the quiet rural village of New Leake. The accommodation comprises of three double-bedrooms and a family bathroom with a separate shower. Plus, the kitchen flows into a conservatory, which overlooks the far-reaching rural paddock views to the rear of the home, and the spacious reception room includes patio doors through to the conservatory. There is parking out front with a lawn, beds and a long garage. Located in New Leake which is more or less an equal distance between Boston and Skegness for shops, schools and services.

Please call Bruce Mather to arrange a viewing strictly by appointment only on 01205365032.

Floor Plan

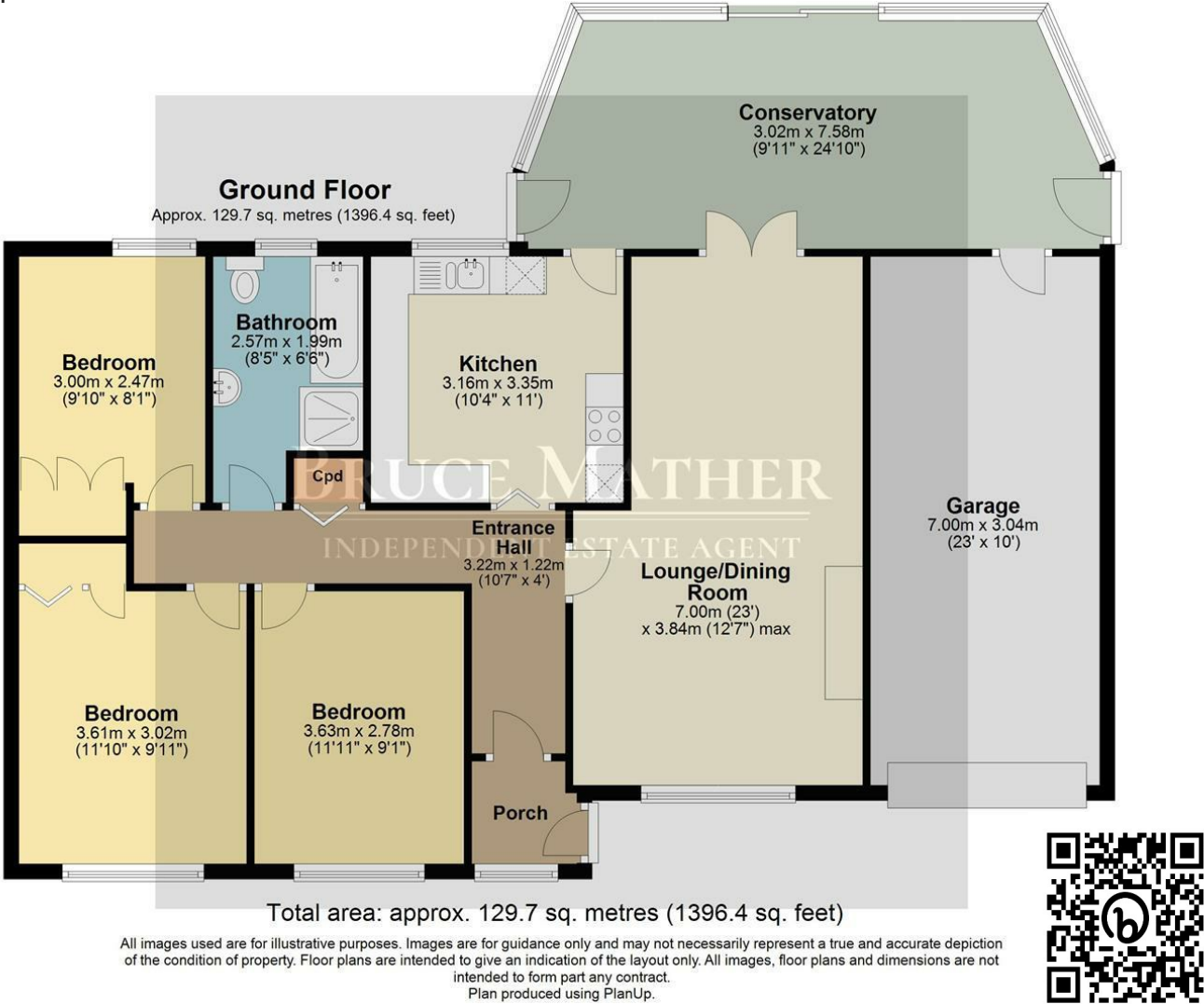

Area Map

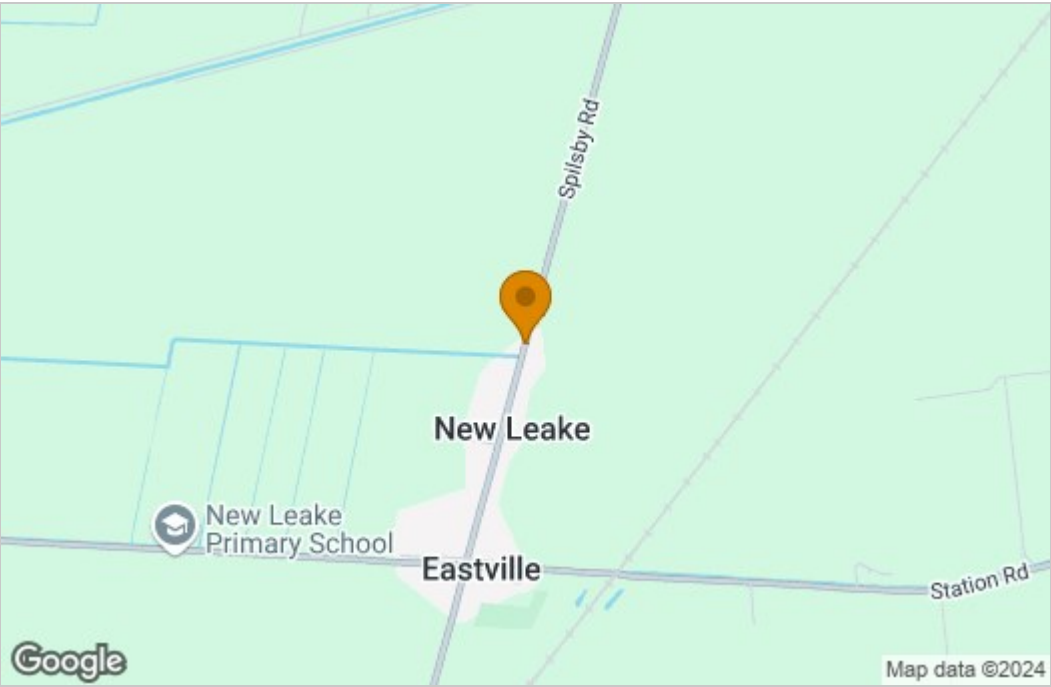

Energy Efficiency Graph

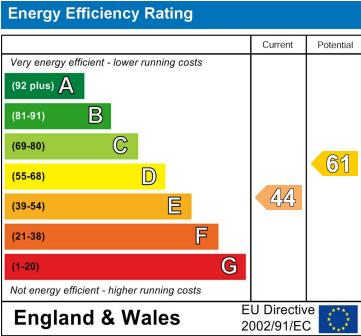

These particulars, whilst believed to be accurate are set out as a general outline only for guidance and do not constitute any part of an offer or contract. Intending purchasers should not rely on them as statements of representation of fact, but must satisfy themselves by inspection or otherwise as to their accuracy. No person in this firms employment has the authority to make or give any representation or warranty in respect of the property.